

INSTRUCCIONES DE MONTAJE

ASSEMBLY INSTRUCTIONS / INSTRUCTIONS DE MONTAGE / MONTAGEANLEITUNGS

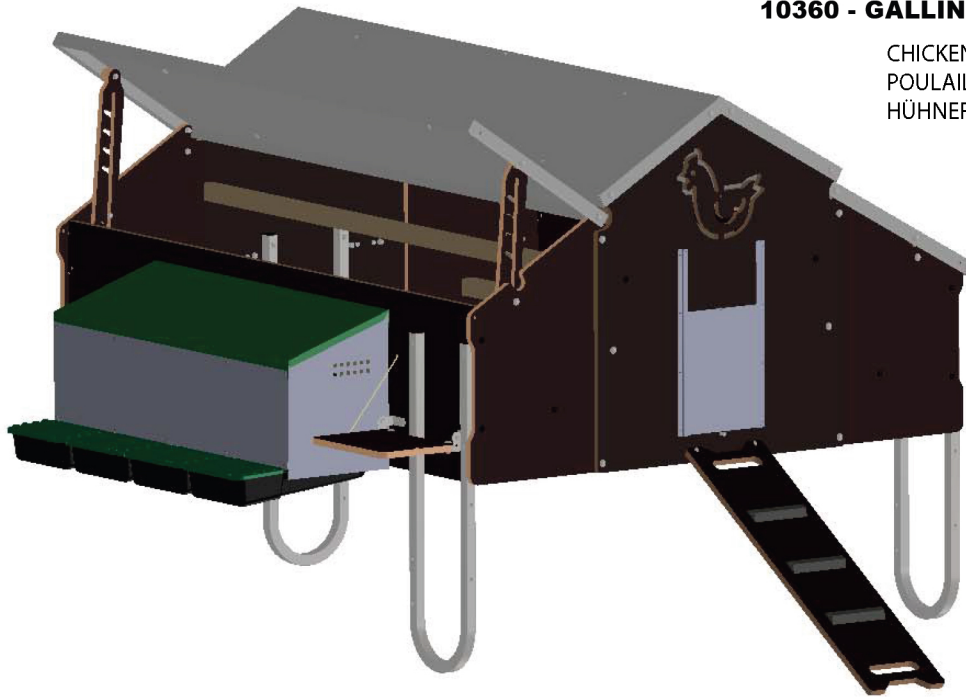

10360 - GALLINERO - 1,5X1,8 Mt.

CHICKEN HOUSE - 1.5 x 1.8 MT.
POULAILLER - 1.5 x 1.8 MT.
HÜHNERSTALL - 1.5 x 1.8 MT.

10361 - KIT DESPLAZAMIENTO PARA GALLINERO - 1,5X1,8 Mt.

WHEEL KIT FOR CHICKEN HOUSE - 1.5 x 1.8 MT.
KIT DEPLACEMENT POULAILLER - 1.5 x 1.8 MT.
UMZUGSSET FÜR MOBILER HÜHNERSTALL - 1.5 x 1.8 MT.

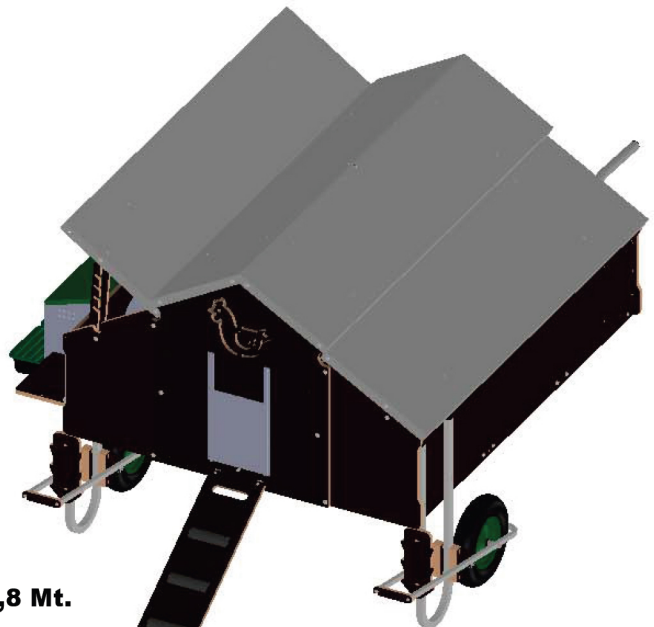
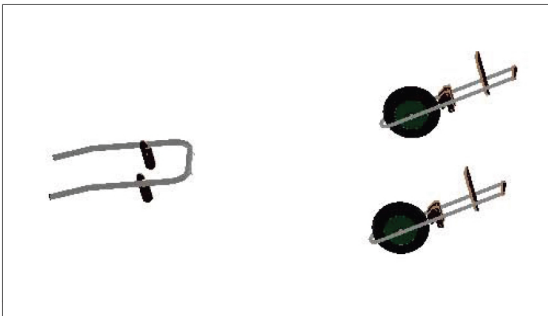

10340 - GALLINERO MÓVIL - 1,5X1,8 Mt.

MOBILE CHICKEN HOUSE - 1.5 x 1.8 MT.
POULAILLER MOBILE - 1.5 x 1.8 MT.
MOBILER HÜHNERSTALL - 1.5 x 1.8 MT.

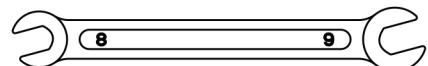

8 - 9
10 - 11
12 - 13

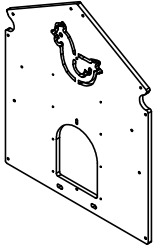

A x1

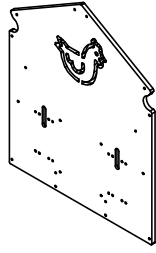

B x1

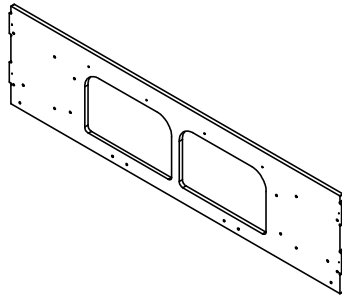

C x1

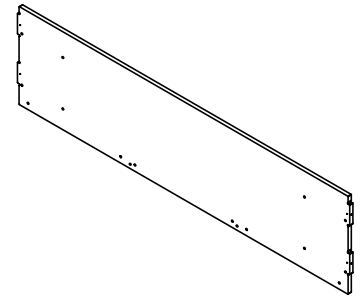

D x1

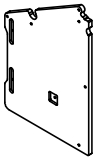

E x2

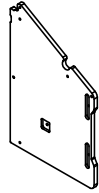

F x2

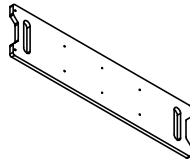

G x1



H x2



I x1

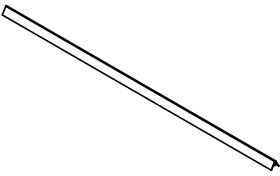

J x6

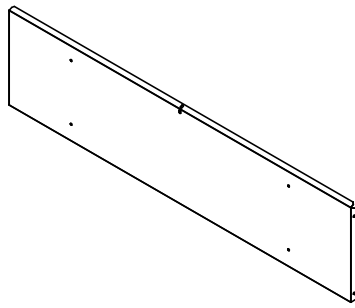

K x2

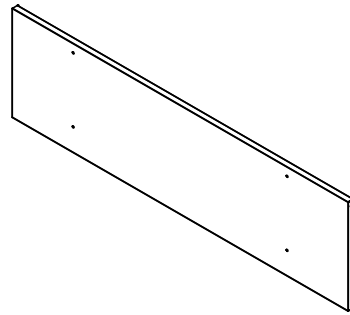

L x2

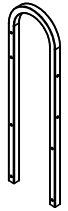

M x3

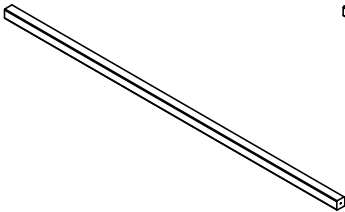

N x2
1864 mm

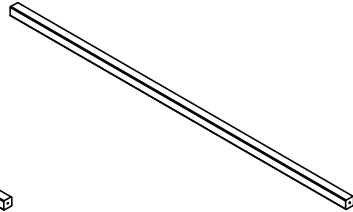

O x2
1882 mm

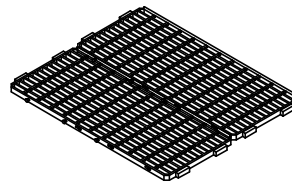

P x9



Q x4

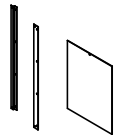

R x1



S x4



T x2



U x3



V x1



A2 x1

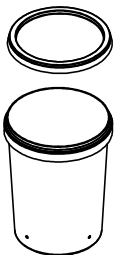

W x1

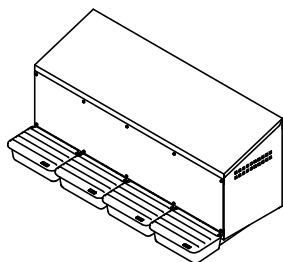

X x1



Y x12



Z x4



A1 x1

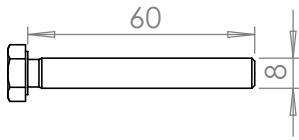

DIN 931 M8x60 mm
x12

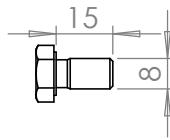

DIN 933 M8x15 mm
x2

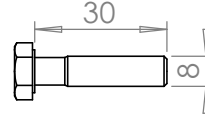

DIN 933 M8x30 mm
x13

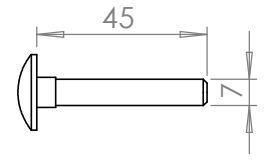

DIN 603 M8x45 mm
x16

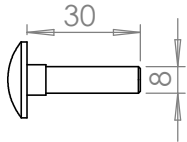

DIN 603 M8x30 mm
x28

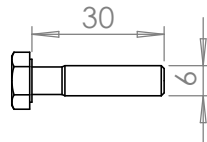

DIN 933 M6x30 mm
x10

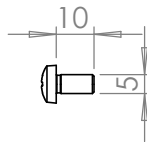

DIN 7985 M5x10 mm
x18

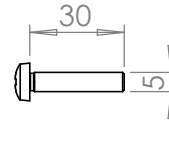

DIN 7985 M5x30 mm
x12

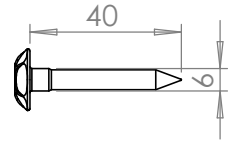

TORX M6x40 mm
x16

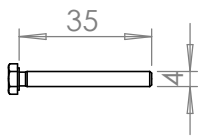

DIN 933 M4x35 mm
x1

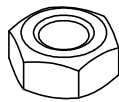

DIN 934 M8
x52



DIN 934 M6
x28



DIN 934 M5
x31

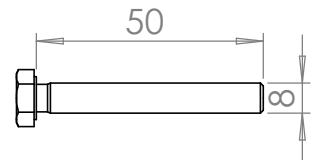

DIN 933 M8x50 mm
x4

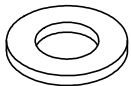

DIN 125 M8
x86

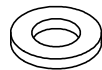

DIN 125 M6
x28



DIN 125 M5
x12

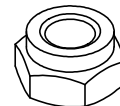

DIN 985 M8 autoblock
x14

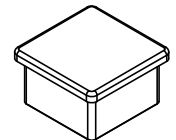

B2 x6

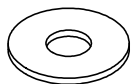

DIN 9021 M5
x18

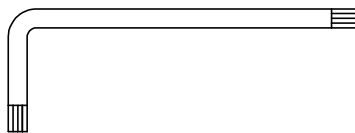

TORX Tx40
x1

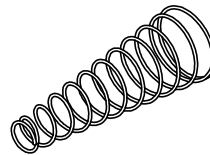

B1 x1

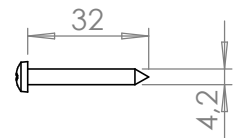

Tornillo autorroscante 4,2x32 mm
x6

PASO 1

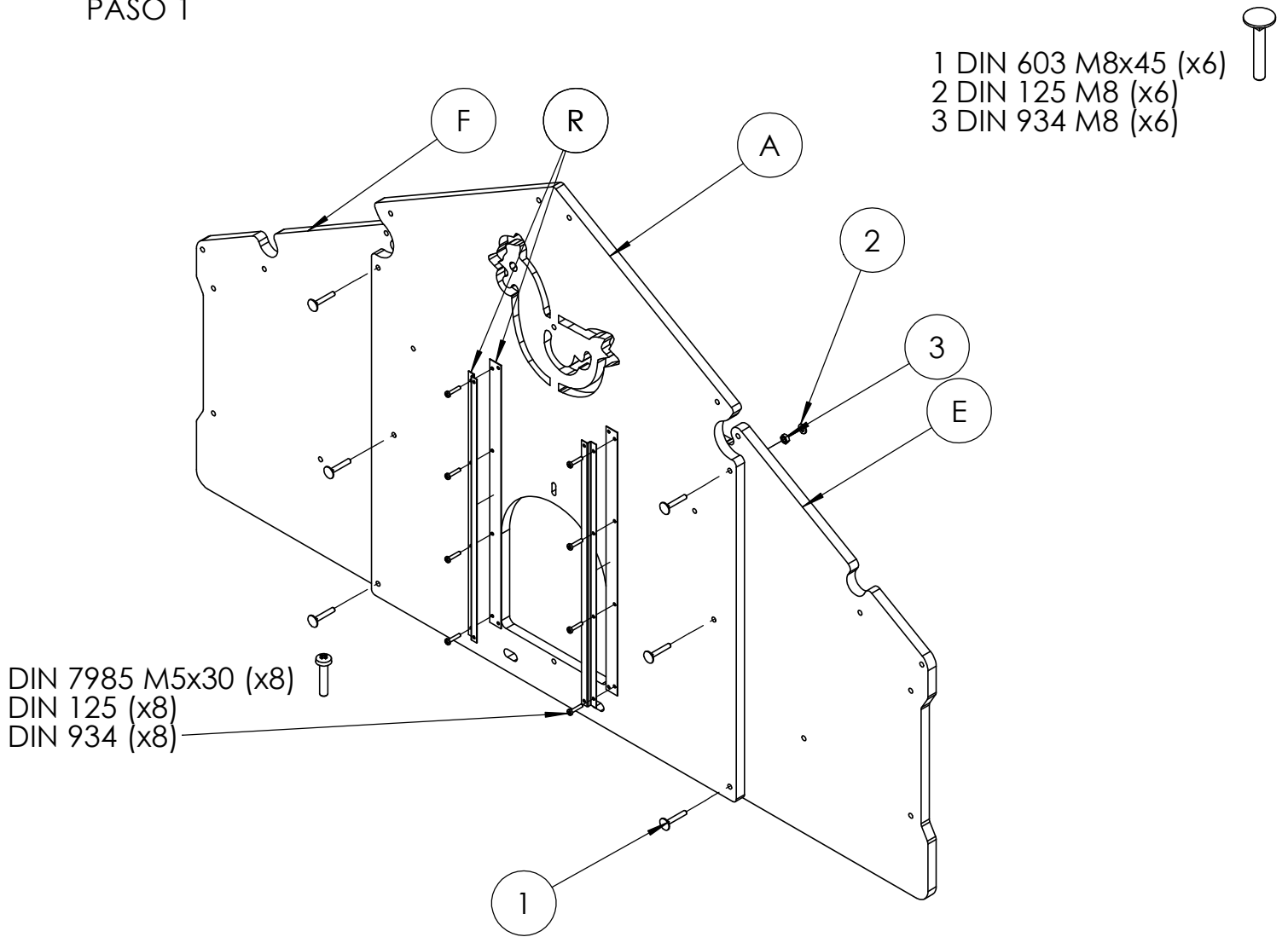

PASO 2

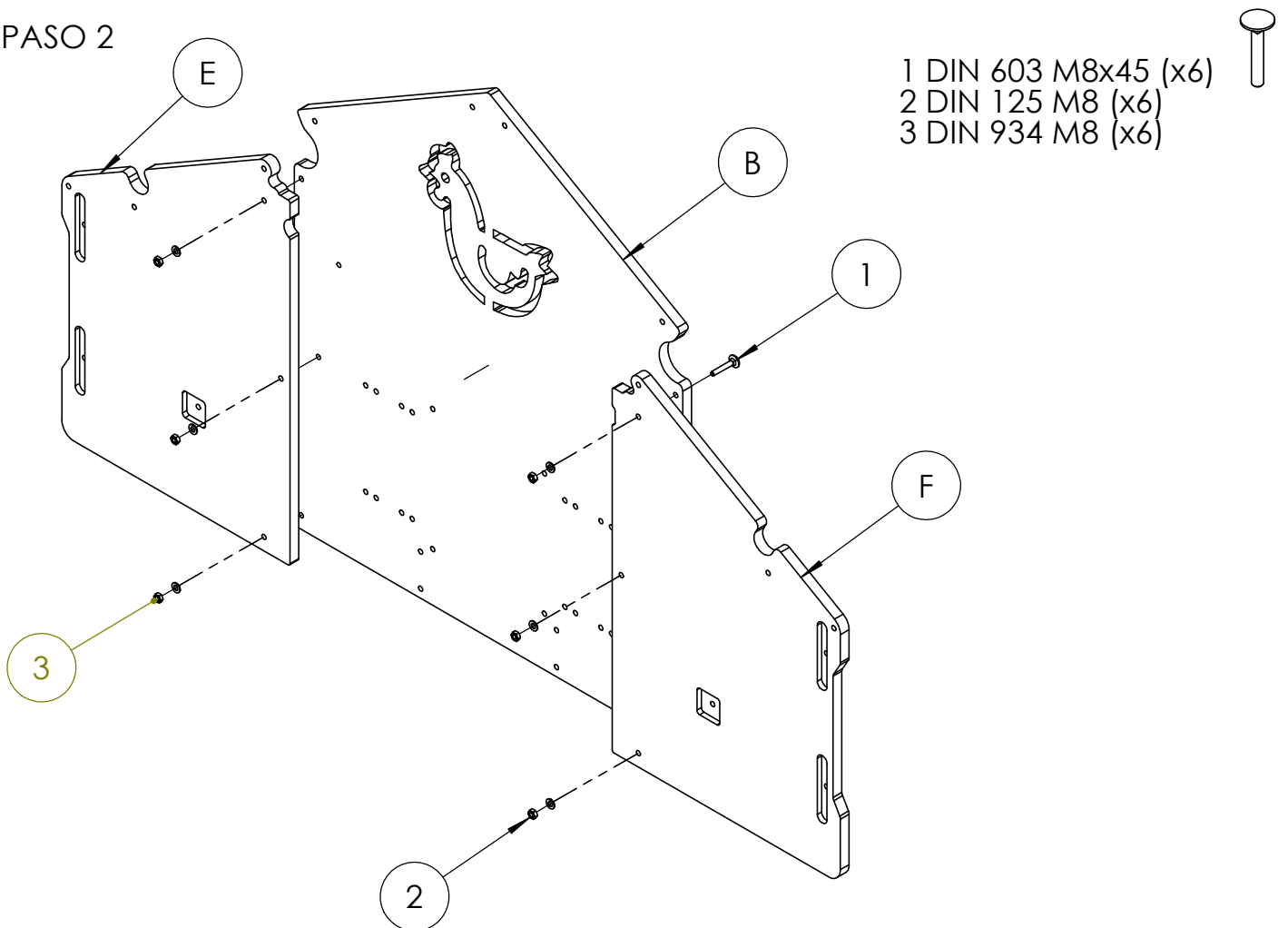

PASO 3

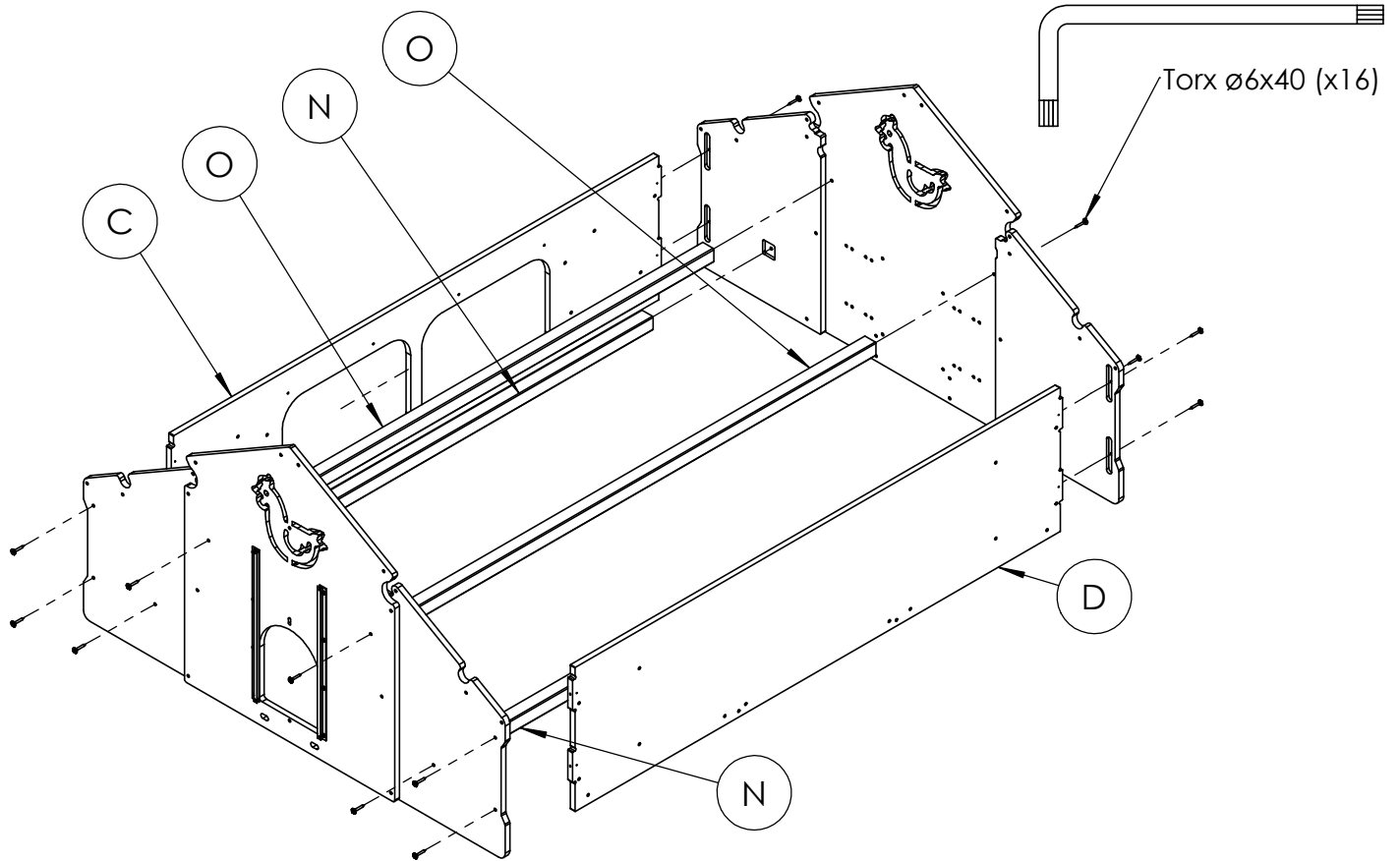

PASO 4

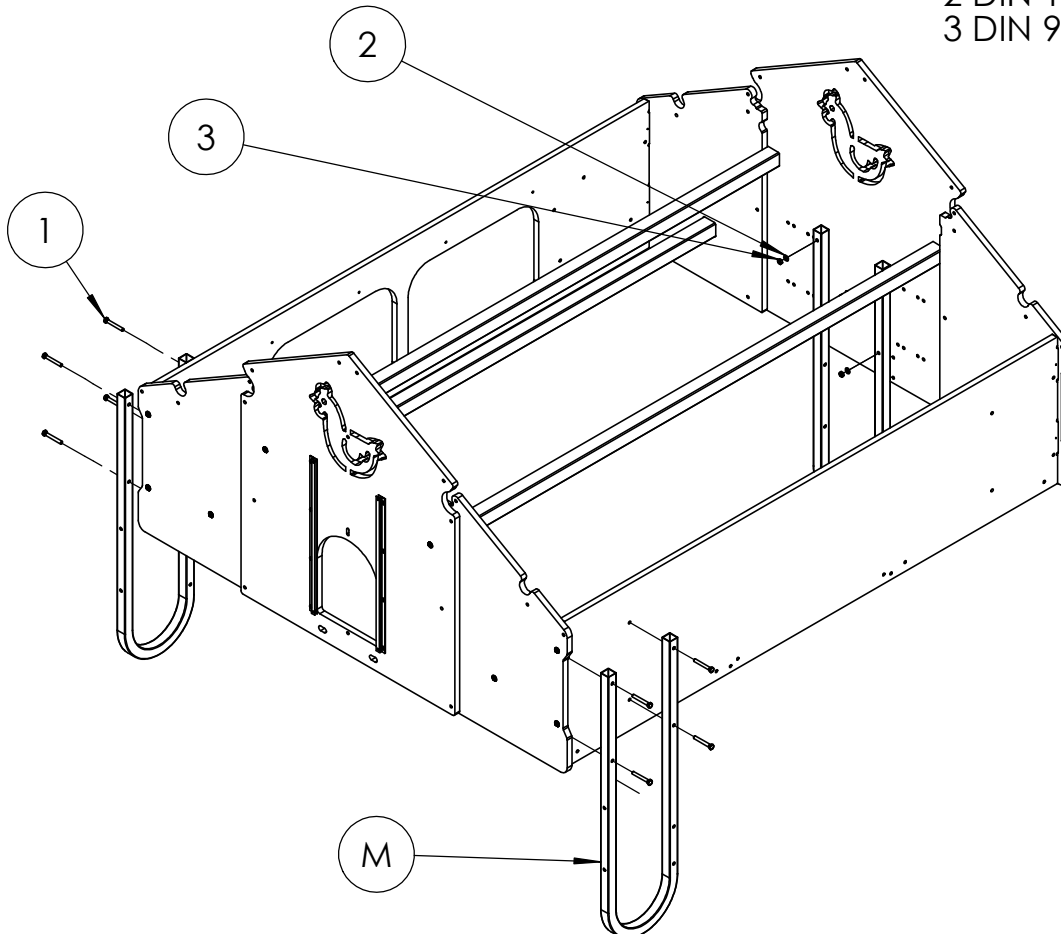

- 1 DIN 931 M8X60 (x12)
- 2 DIN 125 M8 (x12)
- 3 DIN 934 M8 (x12)

PASO 5

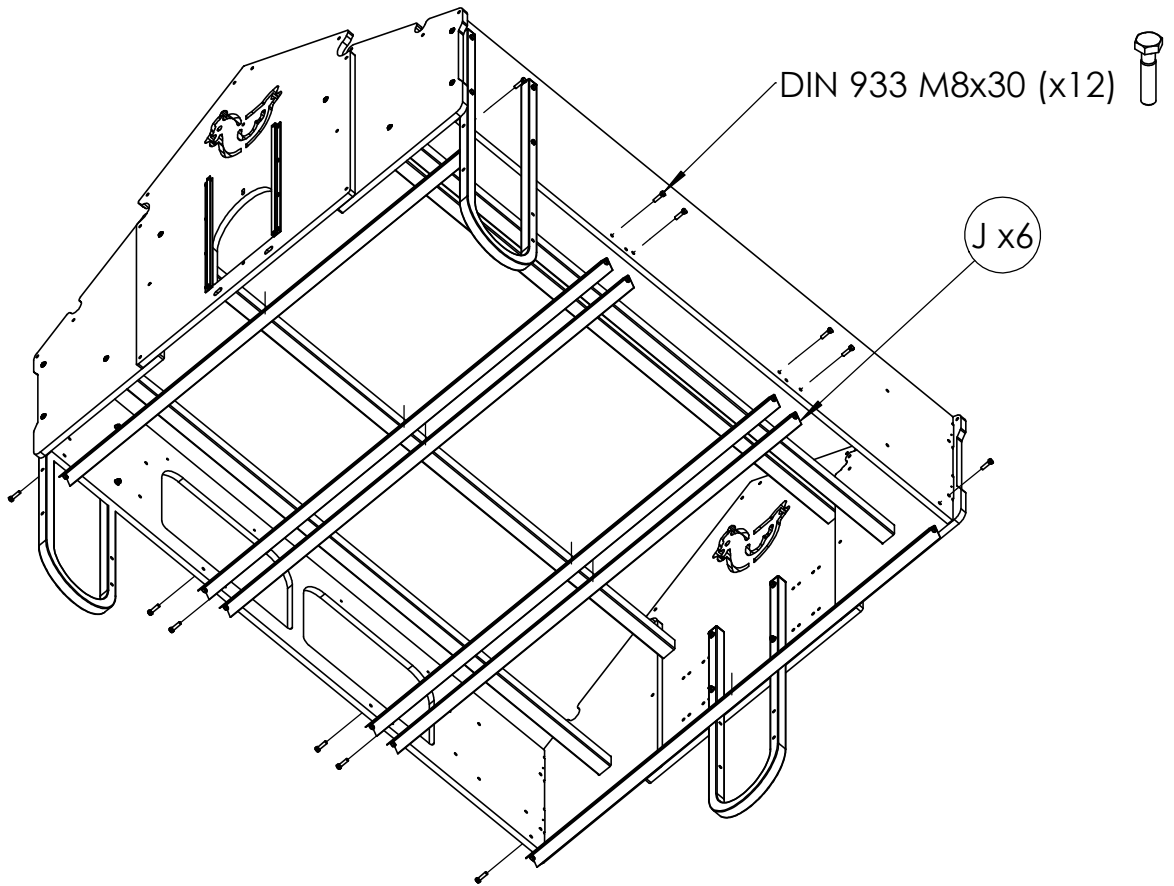

PASO 6

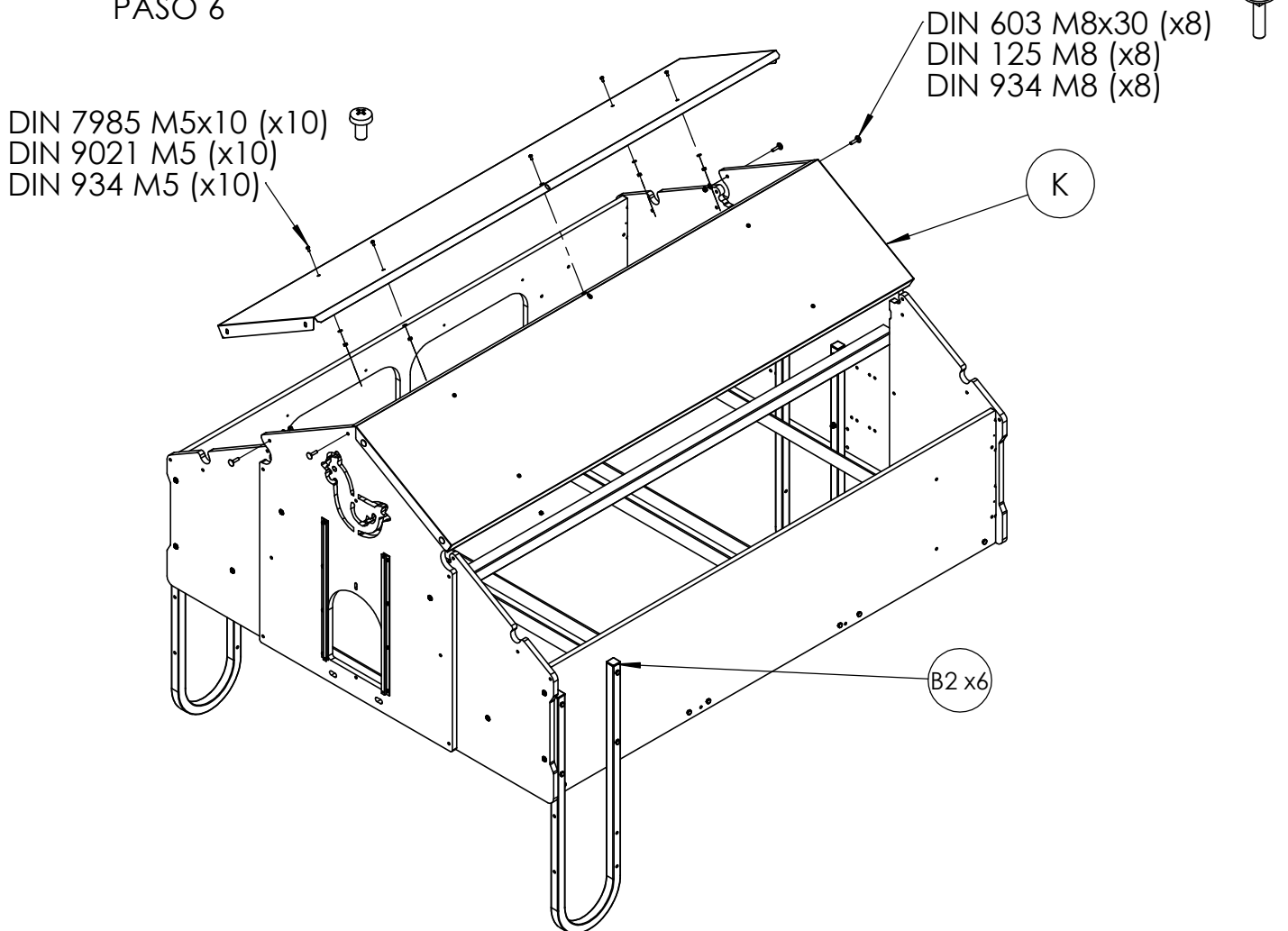

PASO 7

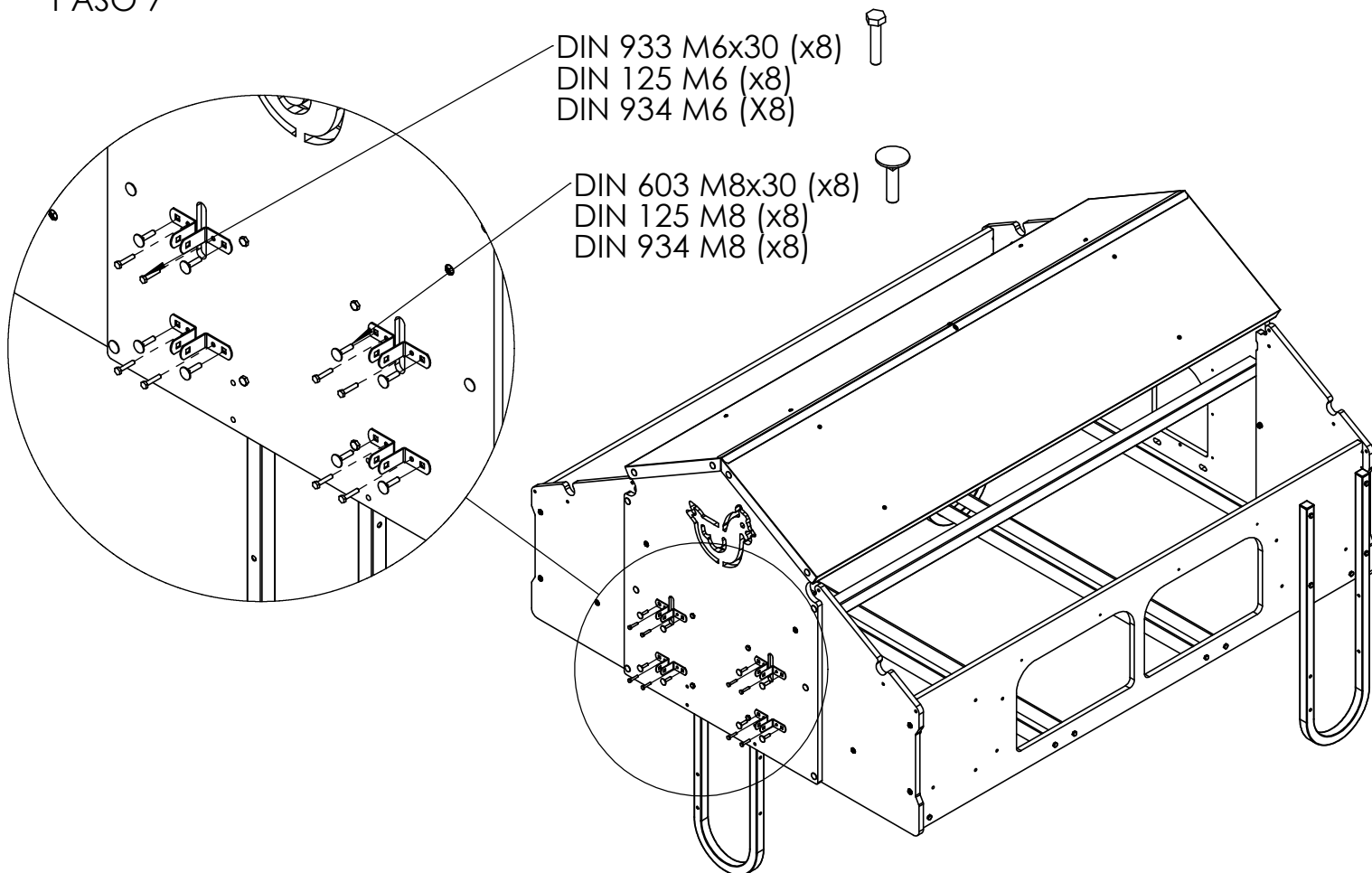

PASO 8

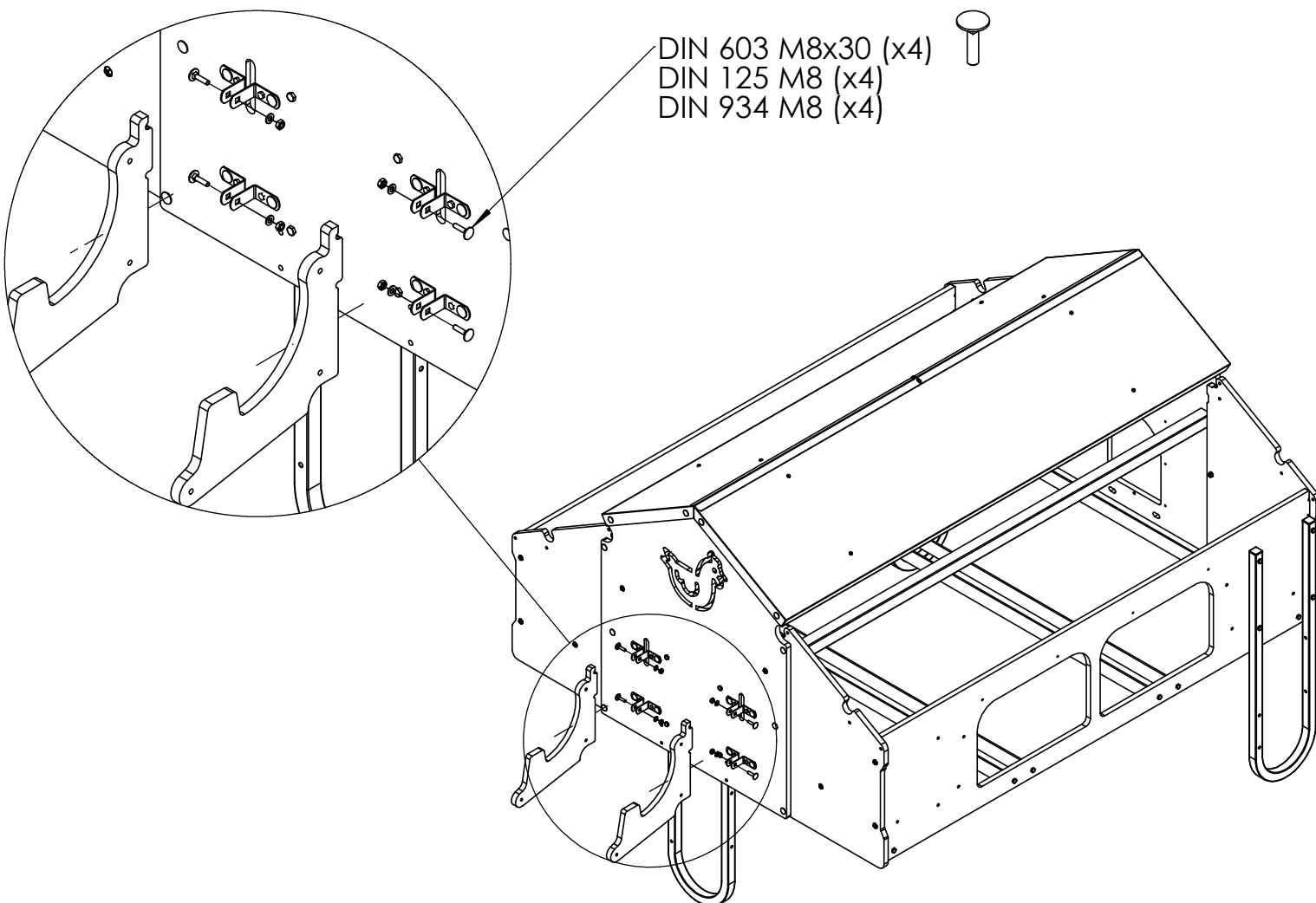

PASO 9

DIN 603 M8x30 (x2)
DIN 125 M8 (x2)
DIN 934 M8 (x2)

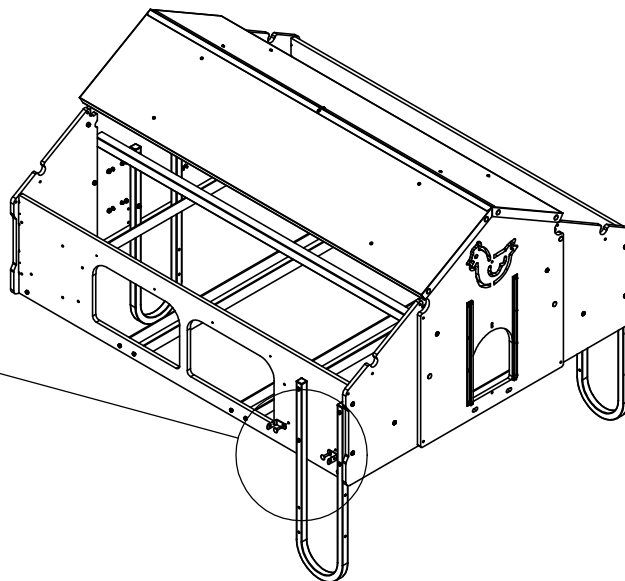
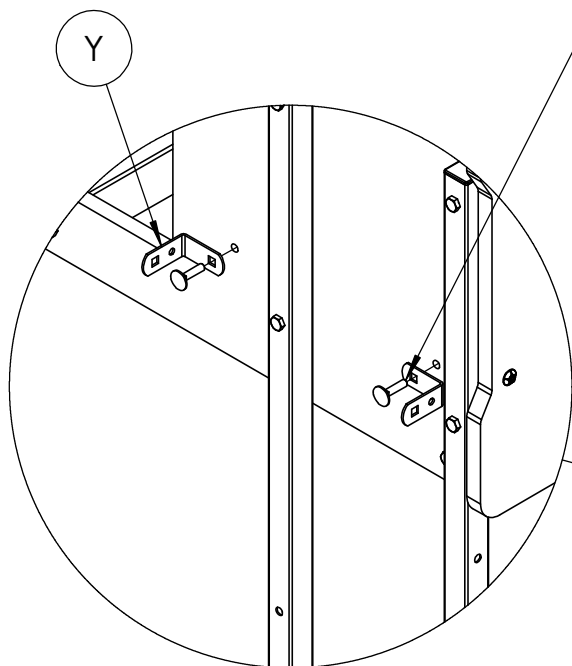

DIN 933 M8x15 (x2)
DIN 125 M8 (x2)
DIN 985 M8 (x2)

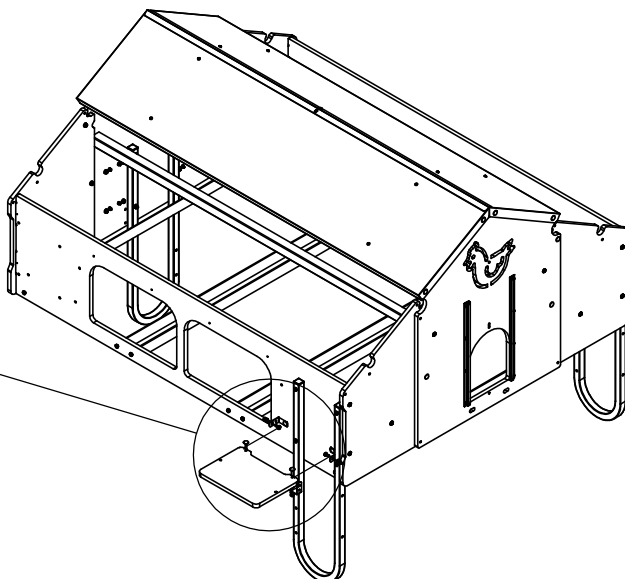
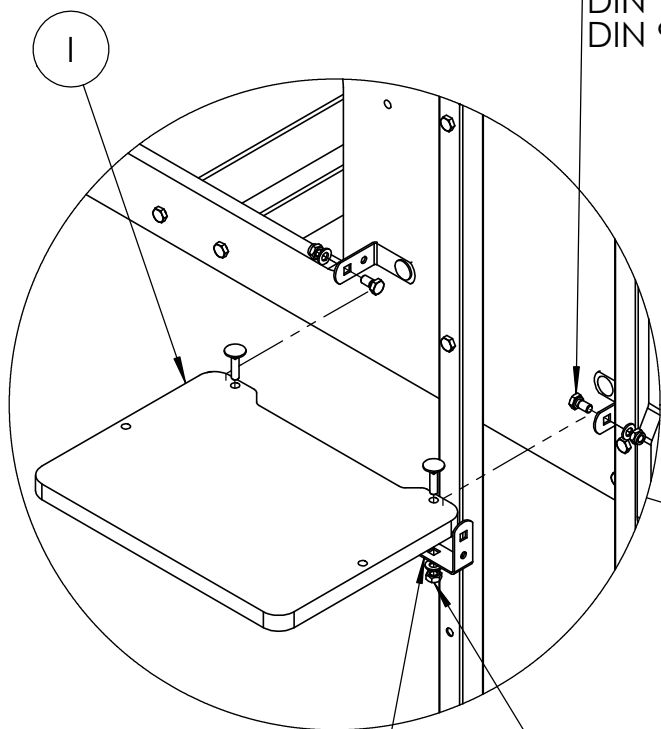

DIN 603 M8x30 (x2)
DIN 125 M8 (x2)
DIN 934 M8 (x2)



PASO 10

DIN 7985 M5x10 (x8) 
DIN 9021 M5 (x8)
DIN 934 M5 (x8)

L

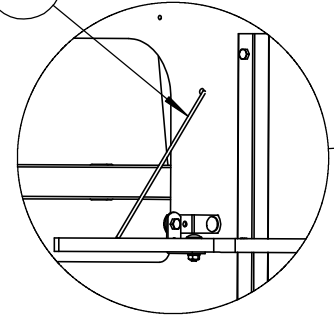
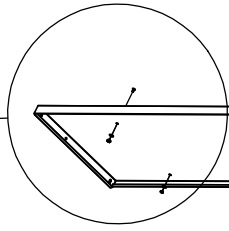
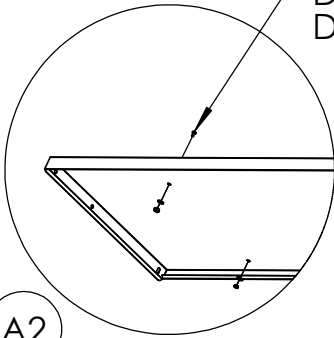

A2

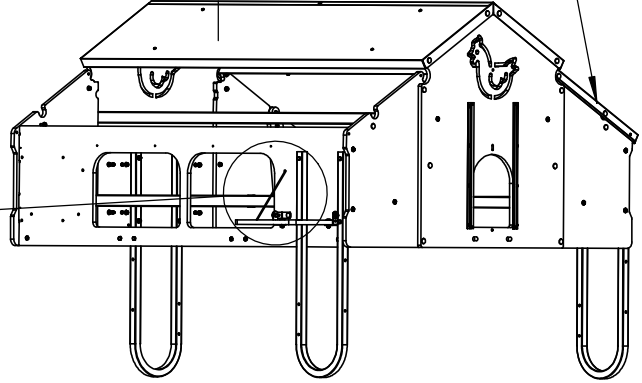

PRESIONAR
PRESS

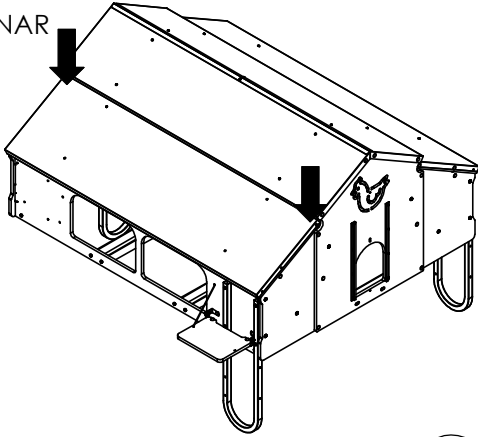

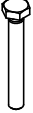
DIN 933 M8x50 (x4) 
DIN 125 M8 (x4)
DIN 985 M8 (x4)

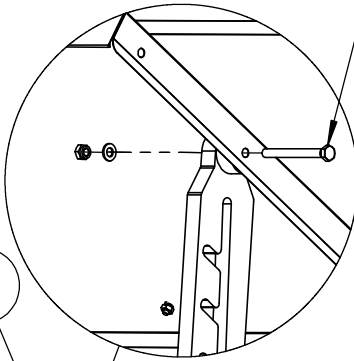

Q

Q

R

DIN 603 M8x30 (x4) 
DIN 125 M8 (x4)
DIN 985 M8 (x4)

R

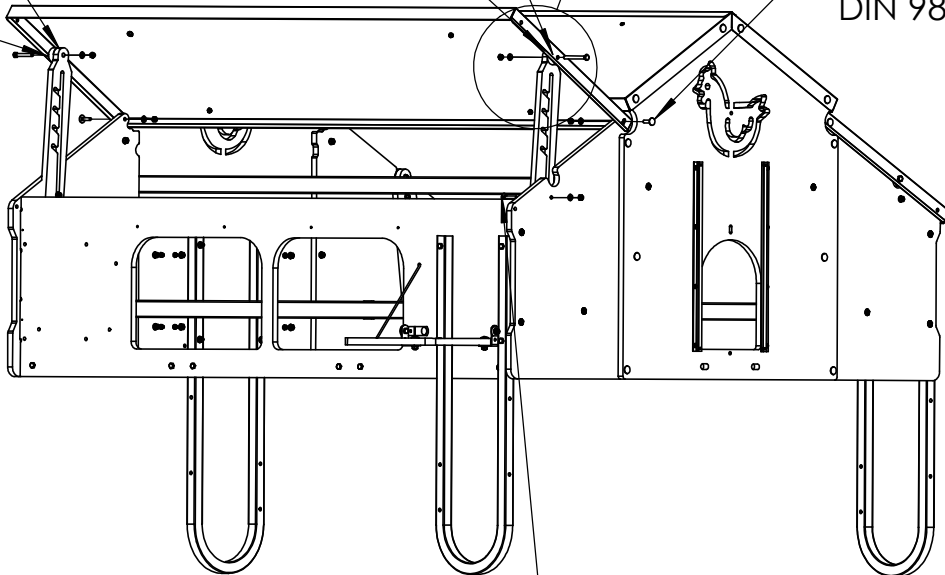

DIN 603 M8x45 (x4) 
DIN 125 M8 (x4)
DIN 985 M8 (x4)

PASO 11

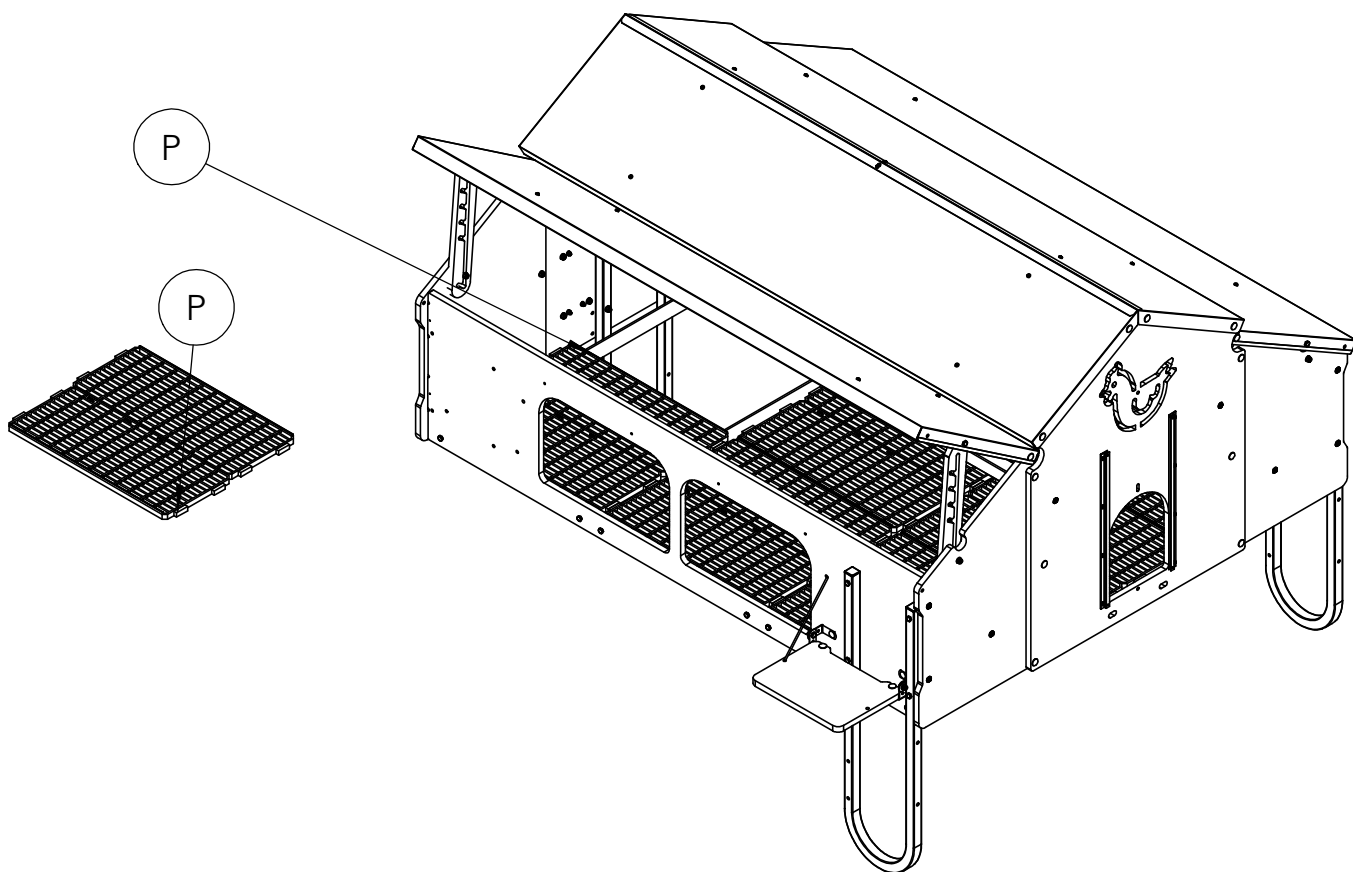

PASO 12

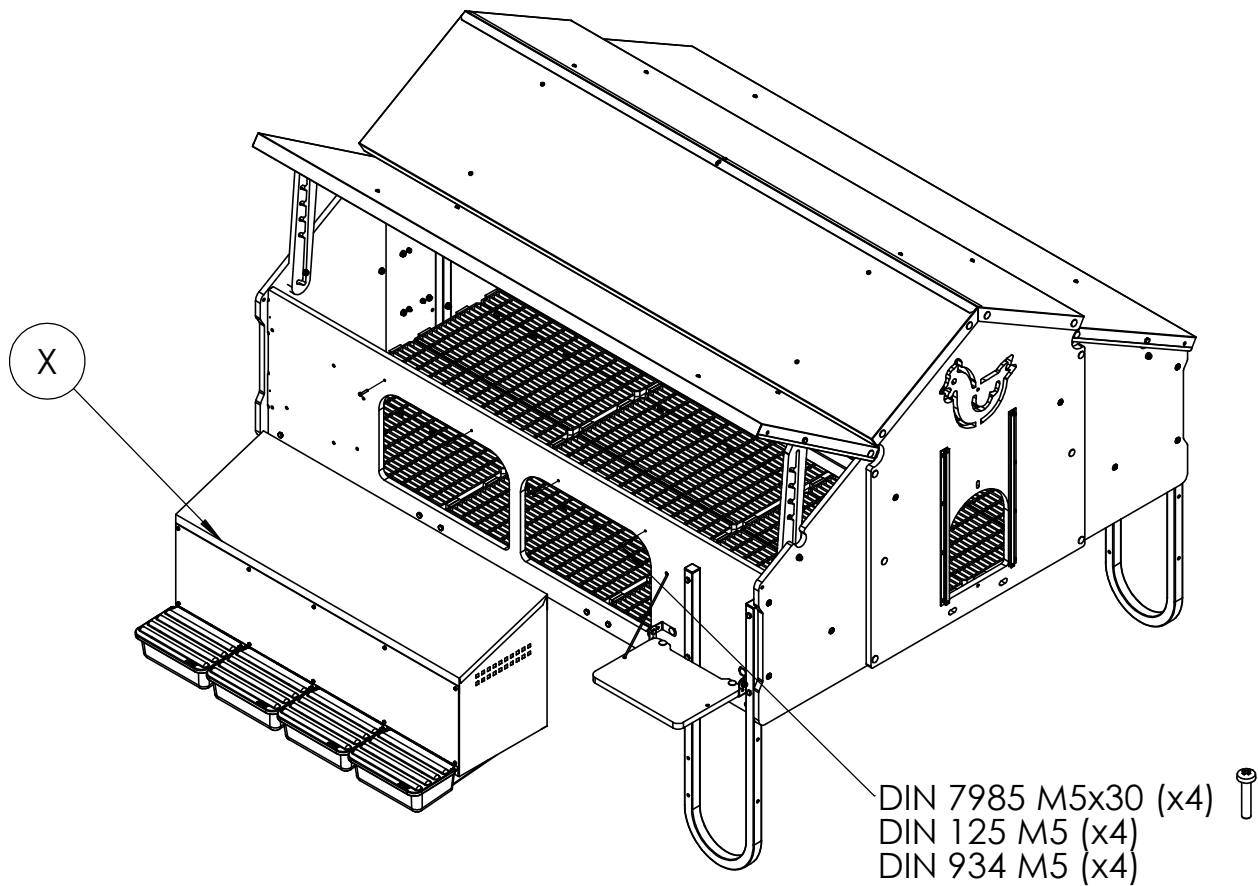

PASO 13

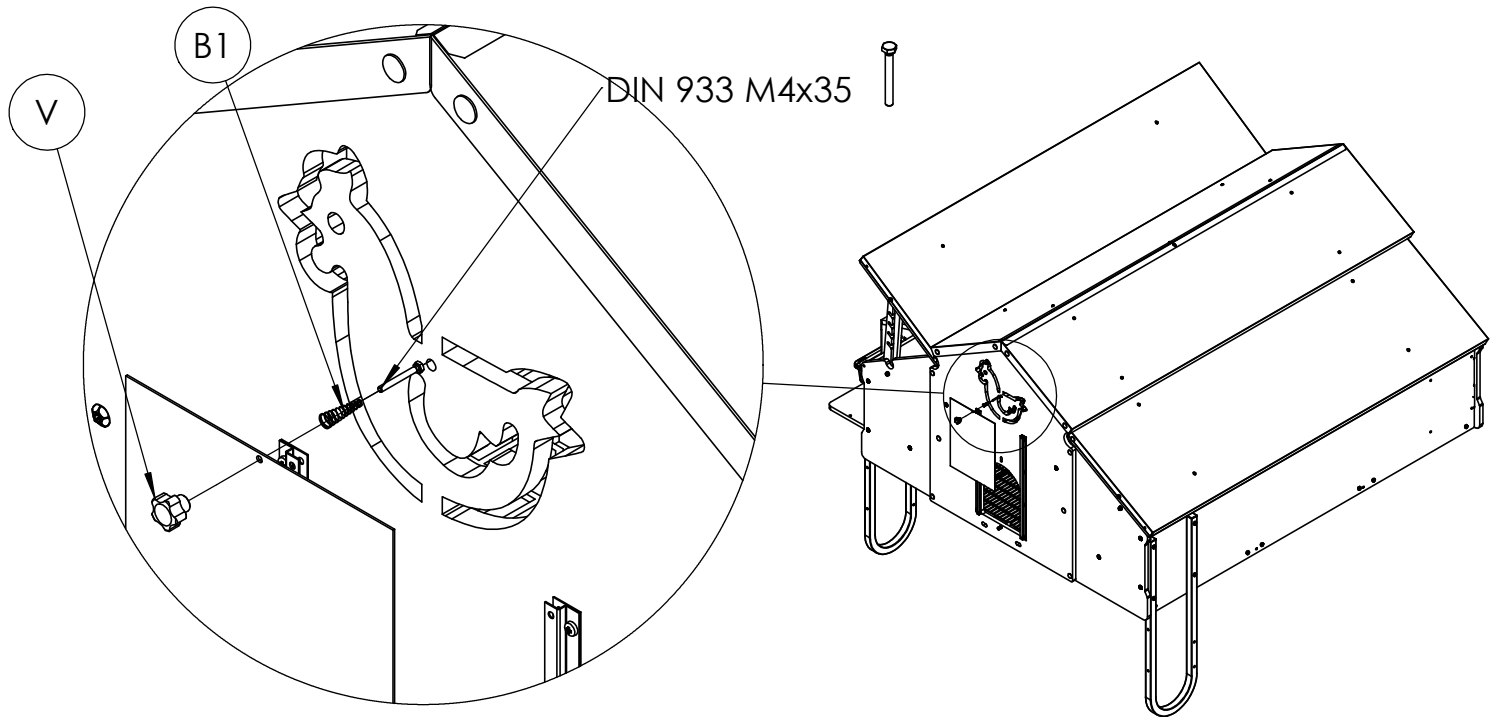
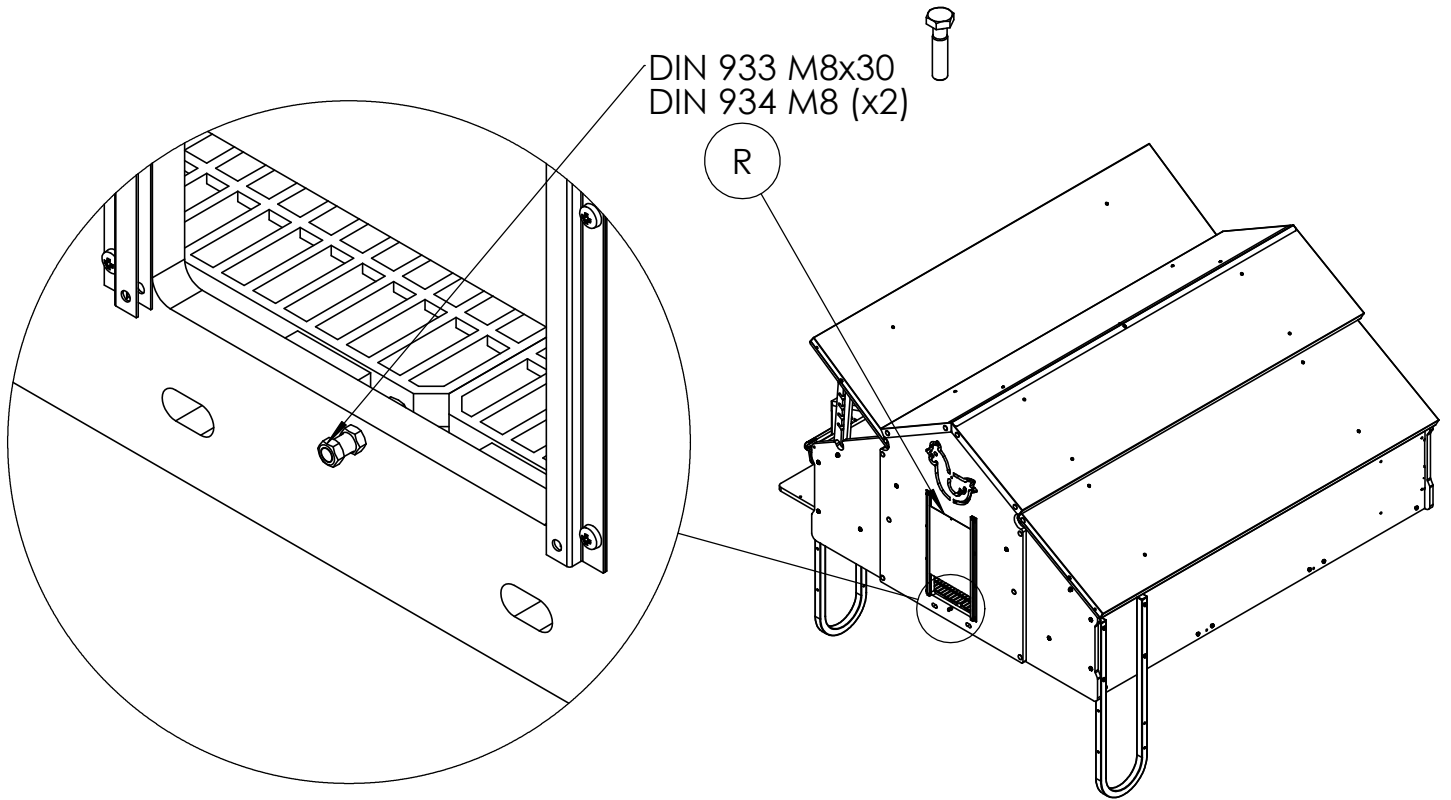

PASO 14

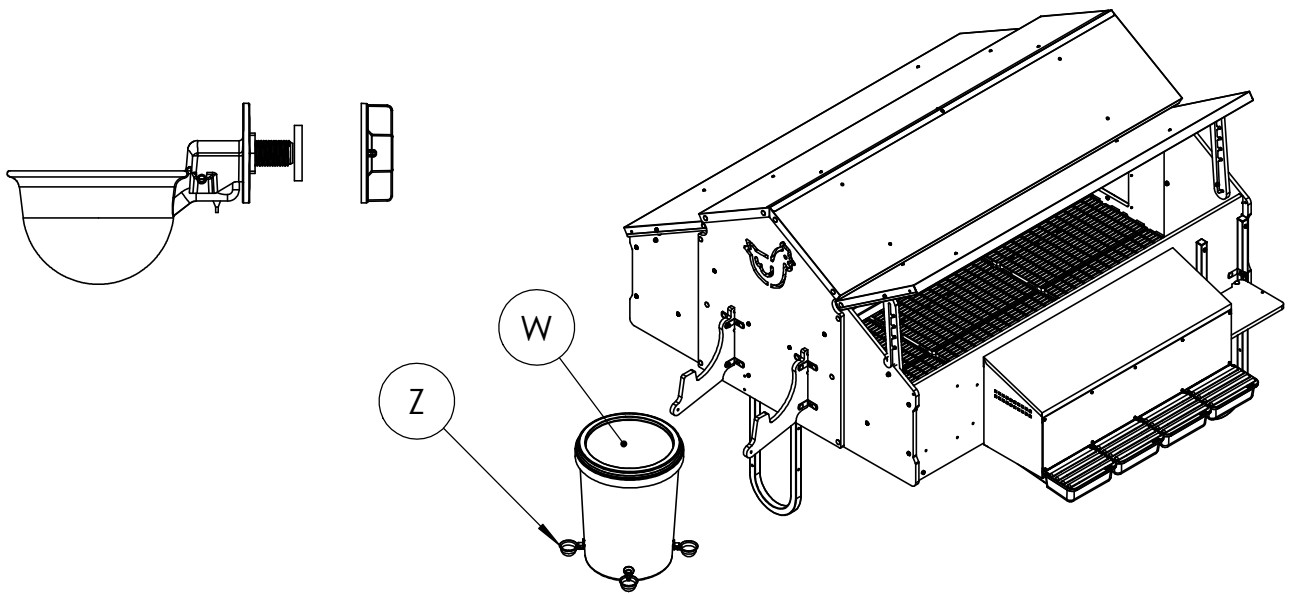

PASO 15

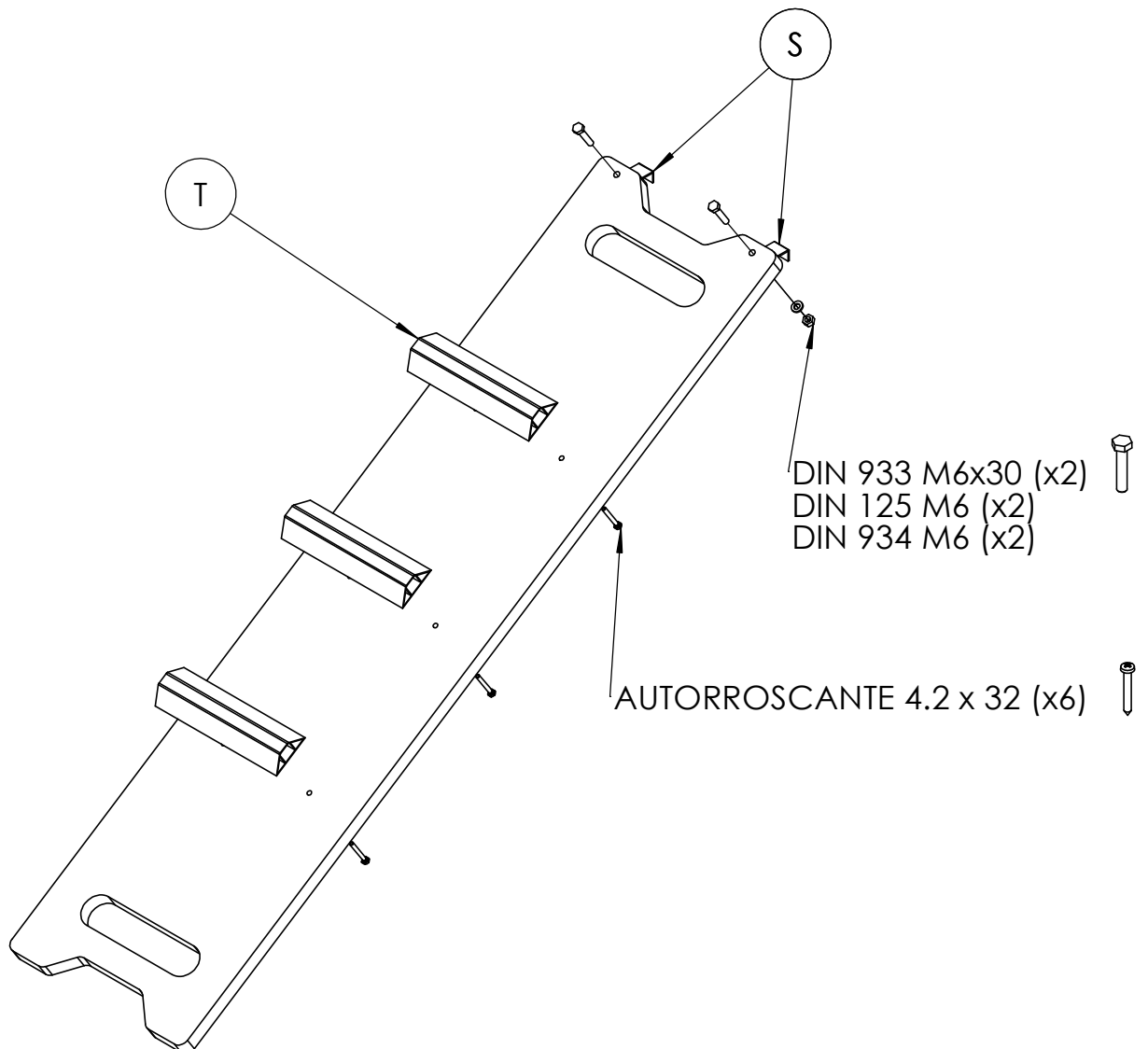

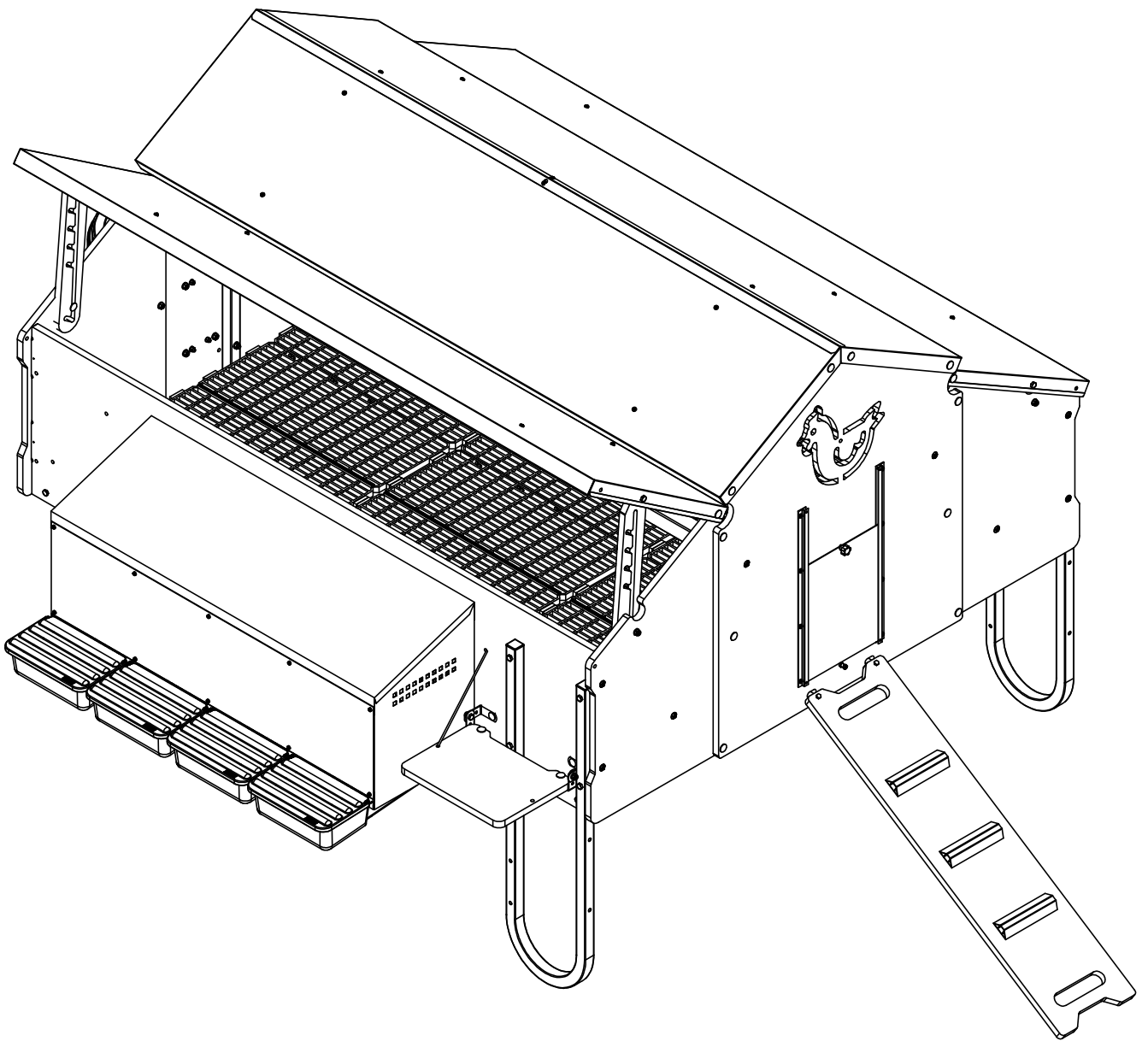
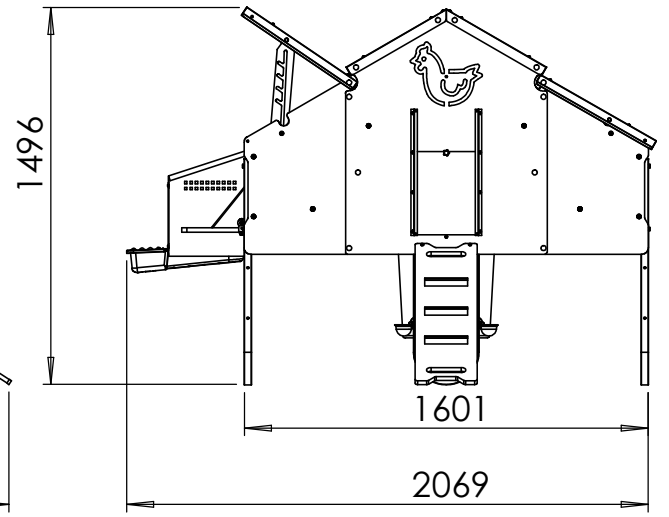
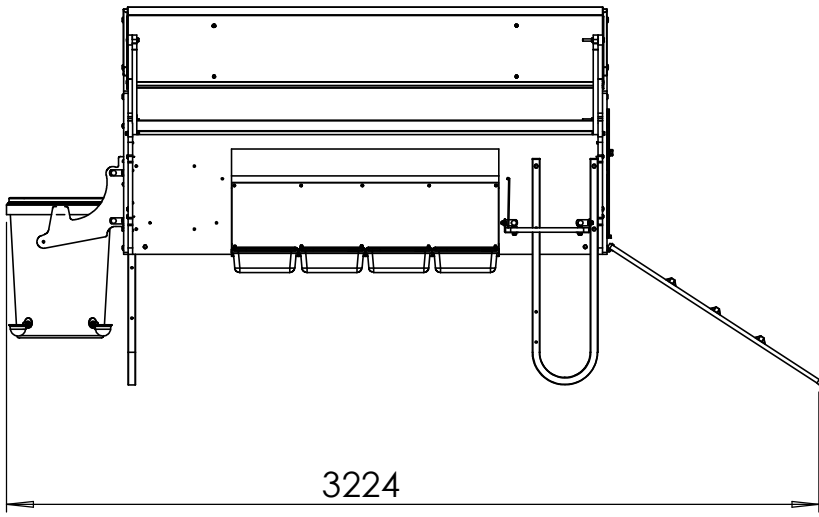

KIT DESPLAZAMIENTO

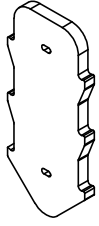

A x2



B x8

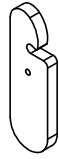

C x2

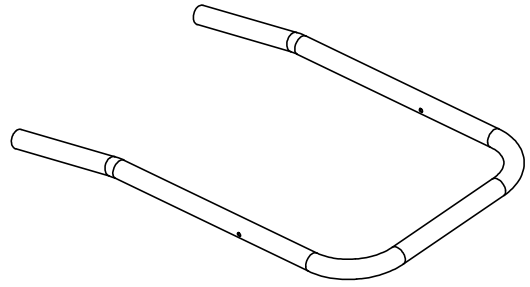

E x1



F x2

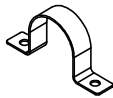

G x2

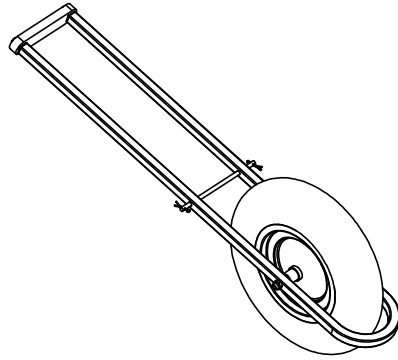

H x2

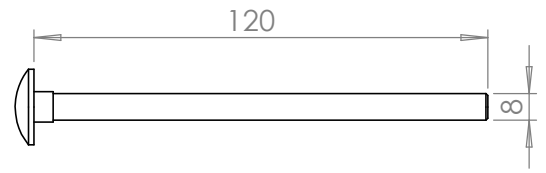

DIN 603 M8x120 mm
x4

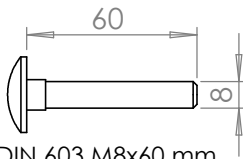

DIN 603 M8x60 mm
x4

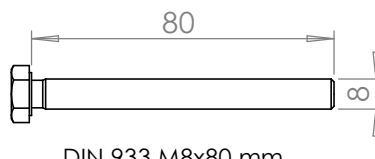

DIN 933 M8x80 mm
x2

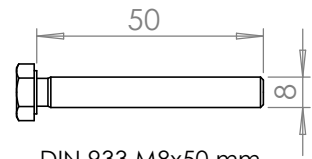

DIN 933 M8x50 mm
x2



DIN 933 M6x30 mm
x4



DIN 985 M8
x2



DIN 934 M8
x10



DIN 9021 M6
x4



DIN 934 M6
x4



DIN 125 M8
x10

PASO 1

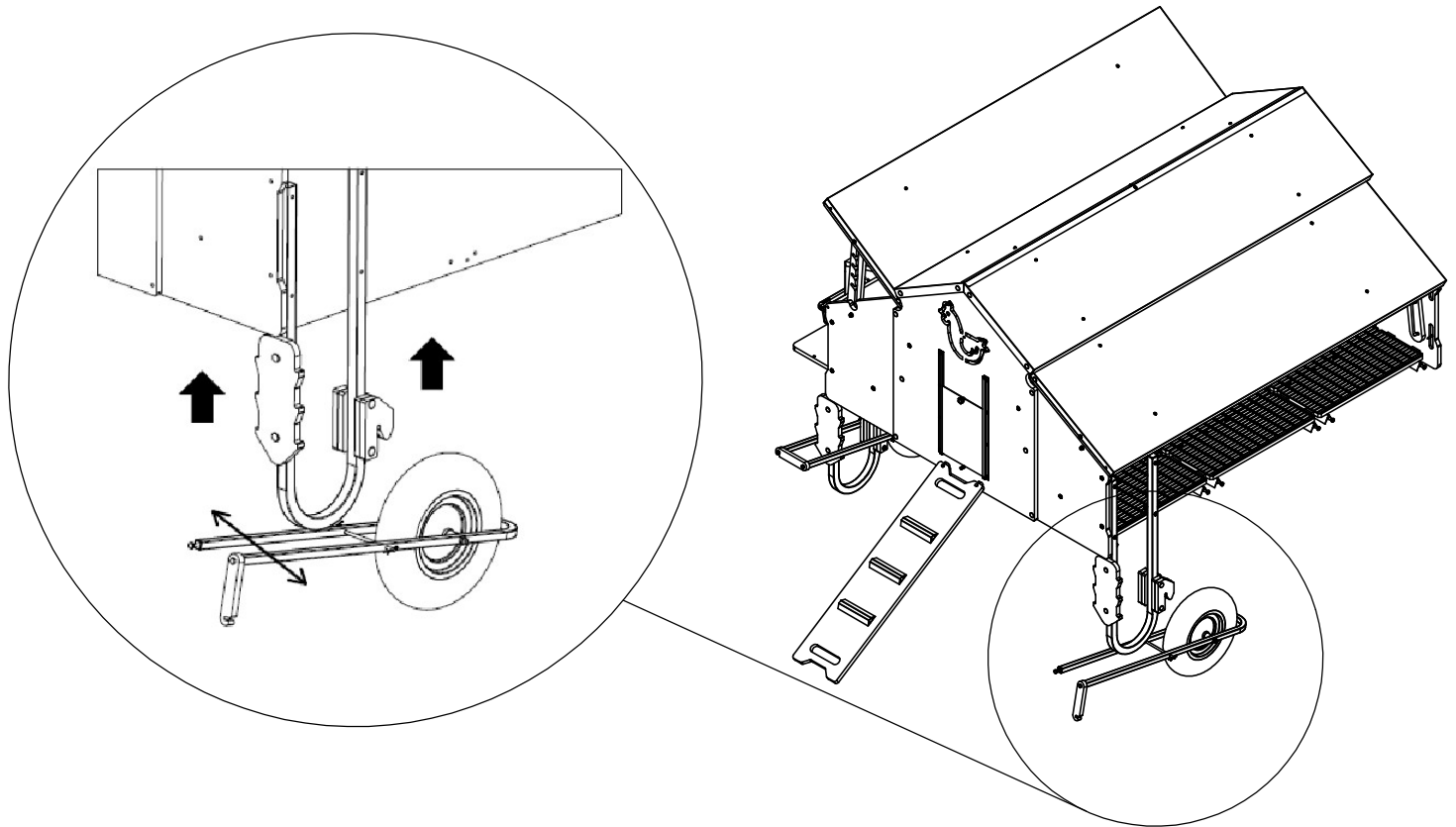
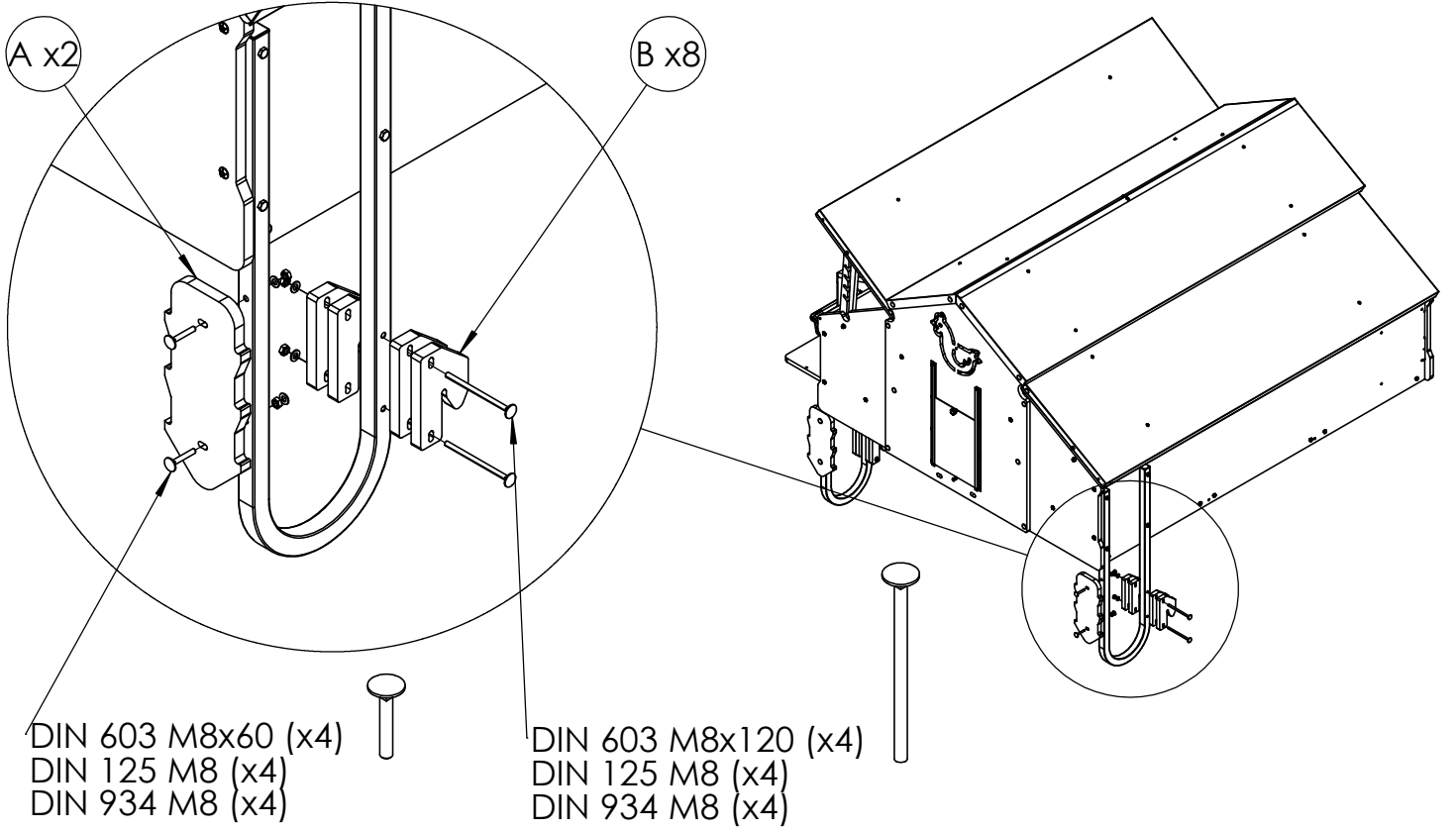

PASO 2

DIN 933 M6x30 (x4)
DIN 125 M6 (x4)
DIN 934 M6 (x4)

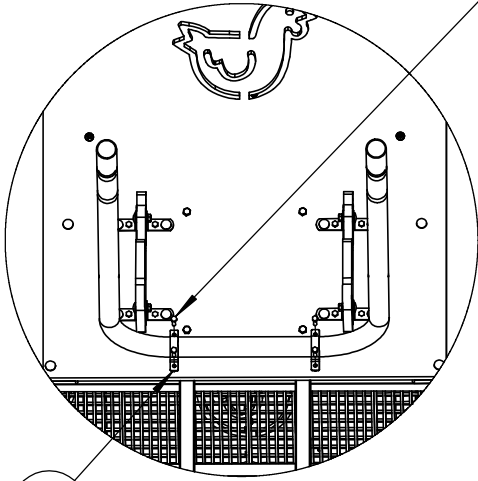

G

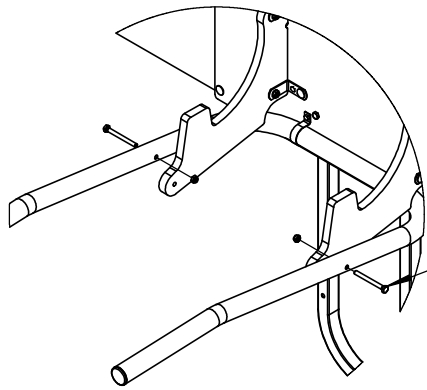
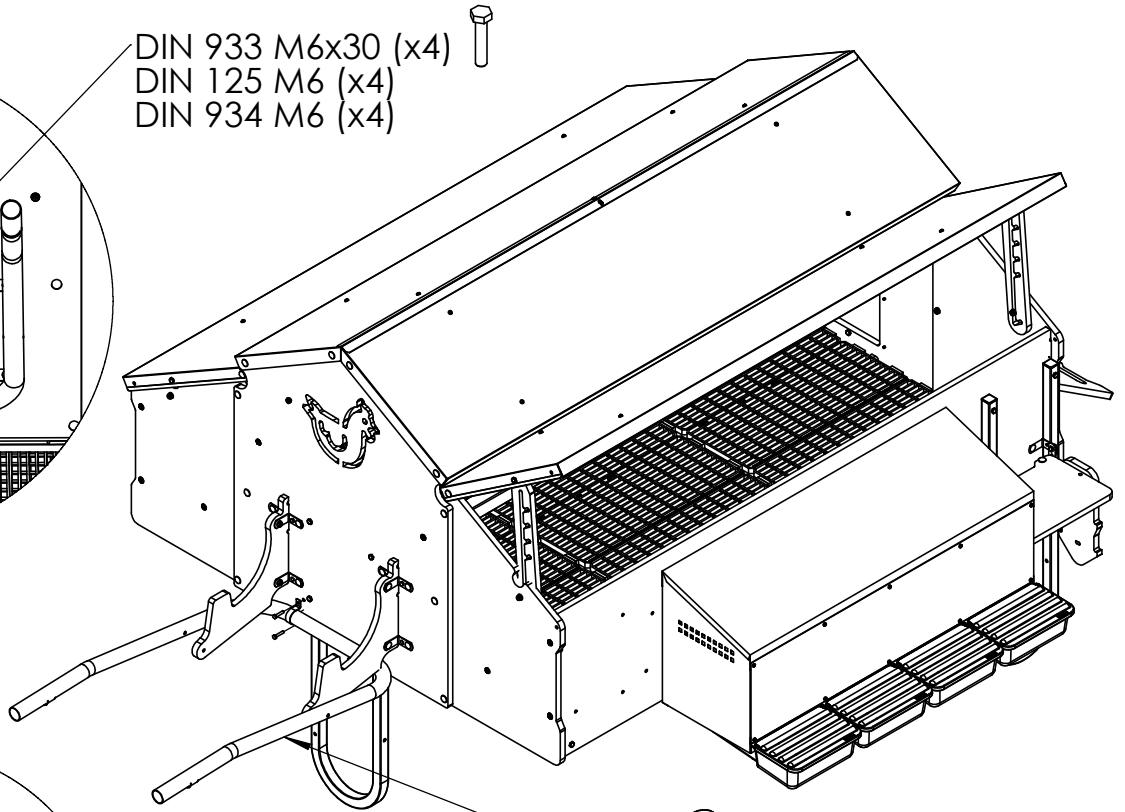

E

DIN 933 M8x80 (x2)
DIN 934 M8 (x2)

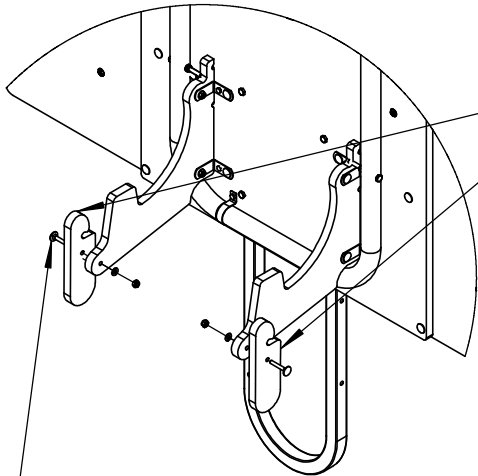

C

DIN 933 M8 x50 (x2)
DIN 125 M8 (x2)
DIN 985 M8 (x2)

